

SLIM 82 T WINDOW & DOOR SYSTEM

SLIM82 T , with 82 mm frame depth, is one of the slimmest systems designed, which has minimum visible width for frame and sash, and wide spacing windows and doors.

In addition to slim frame and sash combination specialty, with its steel view essentials, it provides ideal solution for renovation projects and new buildings.

The system features all kinds of desired openings and alternatives of use for windows & doors such as inward - outward opening, tilt & turn opening, vasistas window. At the same time, it can also be used with PVC opening mechanism.

It has a profile wall thickness between 2.0 mm and 6.6 mm, the system allows glass usage up to 67 mm thickness. The system has 82 mm frame depth and 92mm sash depth.



SLIM 82 T WINDOW & DOOR SYSTEM

TECHNICAL SPECIFICATIONS

- Frame Depth: 82 mm
- Sash Depth: 92 mm
- Min. Visible View for Fixed: 47.5 mm
- Min. Visible View for Inside Opening Sash: 87.9 mm
- Glass Thickness: between 4 mm and 67 mm
- Max. Window (width x height): 1600 mm x 2400 mm

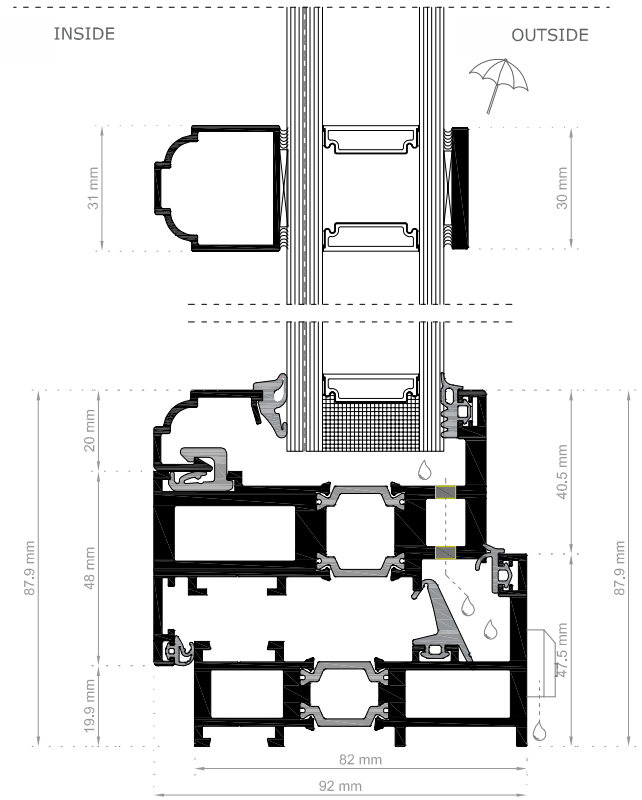

WINDOWS

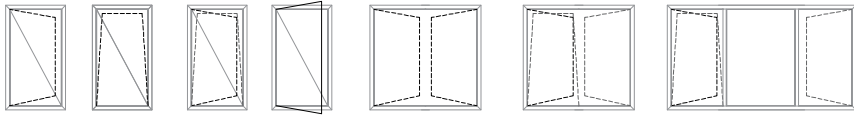

--- inward opening
 — outward opening

DOORS

